

LINE TERMINAL DETAIL

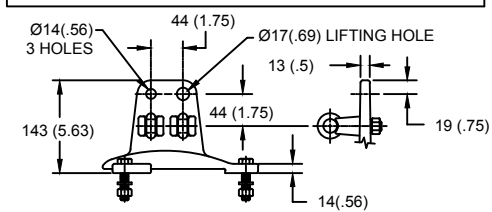

HDG 4-HOLE TERMINAL PAD, PART No. 901704001
 TWO HDG TERMINALS, PART No. 2714143001
 SUITABLE FOR COPPER OR ALUMINUM CONDUCTOR SIZE
 Ø 7 (.25) - Ø 21 (.81)
 25 - 240 sq mm
 AWG#4 - 500 MCM

GROUND TERMINAL DETAIL

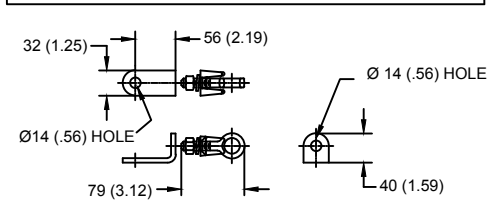

HDG TERMINAL BRACKET, PART No. 896064001
 ONE HDG TERMINAL, PART No. 2714143001
 SUITABLE FOR COPPER OR ALUMINUM CONDUCTOR SIZE
 Ø 7 (.25) - Ø 21 (.81)
 25 - 240 sq mm
 AWG#4 - 500 MCM

Ø = DIAMETER
 HDG = HOT DIP GALVANIZED

CHARACTERISTICS	
RATED VOLTAGE	264 kVrms
MCOV	212 kVrms
MASS	261kg (575lb)
CREEPAGE DISTANCE	7081 (278.8)
LIGHTNING IMP W/S	1119 kV
SWITCHING IMP W/S	965 kV
POWER FREQ W/S	652 kVrms
TOV 1s	316 kVrms
TOV 10s	302 kVrms
COG ABOVE BASE	1292 (50.9)
HOUSING	GREY PORCELAIN
CANTILEVER FORCE	
MAXIMUM CONTINUOUS	2621 N (589lbf)
ULTIMATE (UMS)	6553 N (1473lbf)
RECOMMENDED CLEARANCE (TO METAL PARTS)	
PHASE TO GROUND	1222 (48.1)
PHASE TO PHASE	1395 (54.9)

- NOTES:
 1. DIMENSIONS IN millimeters(inches) SUBJECT TO ±3% TOLERANCE
 2. CLEARANCE AND INSULATION W/S VOLTAGE APPLY AT SEA LEVEL
 3. ARRESTER SUITABLE FOR OPERATION AT ALTITUDES UP TO 2750m (9000ft)

DISCHARGE VOLTAGE (kV) FOR INDICATED IMPULSE TYPES AND CURRENT MAGNITUDES							
FRONT OF WAVE	SWITCHING SURGE	8/20 LIGHTNING IMPULSE					
		1.5 kA	3 kA	5 kA	10 kA	20 kA	40 kA
10 kA	2 kA	545	566	586	615	657	723
667	540						

IEEE C62.11
 STATION CLASS
 SURGE ARRESTER
 Program Revision
 2021.04.27.02.51.45
 REV DATE
09/20/13

CONFIDENTIAL: THIS DRAWING AND ITS CONTENTS ARE CONFIDENTIAL AND THE EXCLUSIVE PROPERTY OF HUBBELL POWER SYSTEMS. NO PUBLICATION, DISTRIBUTION OR COPIES MAY BE MADE WITHOUT THE WRITTEN CONSENT OF HUBBELL POWER SYSTEMS. HUBBELL POWER SYSTEMS UNPUBLISHED ALL RIGHTS RESERVED UNDER THE COPYRIGHT LAWS.

TITLE				MVN ARRESTER 212 KV MCOV			
SIZE	DWG NO.	CAT / PART / ASSY NO.		REV			
S	2118813153	MVN264GA212AA		1			
DO NOT SCALE THIS DRAWING		DRN BY	NON	DATE	04/14/11	SHEET 1 OF 1	